

# LIBRARY VISION SERIES

## 2012 Price List

**CIRCULATION**

PAGE 1

Model #	Description	Product Size (W x D x H)	Ship Wt (lbs)	Suggested Retail
VS-3101	Closed Storage	36 x 30 x 39	210	\$ 1,807.00
VS-3102	90 Degree Radius Corner	30" x 30" x 38-1/2"	170	\$ 1,329.00
VS-3103	Open Storage	35 x 30 x 39	180	1,482.00
VS-3105	Two-Drawer Unit—39H	36 x 30 x 39	315	1,709.00
VS-3108	Depressible Book Truck	28 x 24 x 30	125	2,107.00
VS-3109	Book Truck Storage	36 x 30 x 39	120	1,096.00
VS-3110-O	90 Deg. Open Corner	30 x 30 x 39	90	1,485.00
VS-3111-60	Computer Station	60 x 30 x 39	185	2,226.00
VS-3111-72	Computer Station	72 x 30 x 39	220	2,402.00
VS-3113	End Panel	2 <sup>1</sup> / <sub>4</sub> x 30 x 38	25	347.00
APD	Pencil Drawer	19 x 21 x 2 <sup>1</sup> / <sub>4</sub>	5	87.00



VS-3101

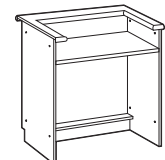

VS-3107

**SINGLE FACED SHELVING**

VS-3261-A	36" Single-Face Shelving Adder	36 x 12 x 35	85	\$586.00
VS-3261-S	36" Single-Face Shelving Starter	37 x 12 x 35	95	683.00
VS-3262-A	48" Single-Face Shelving Adder	36 x 12 x 46	110	676.00
VS-3262-S	48" Single-Face Shelving Starter	37 x 12 x 46	125	781.00
VS-3263-A	60" Single-Face Shelving Adder	36 x 12 x 60	135	783.00
VS-3263-S	60" Single-Face Shelving Starter	37 x 12 x 60	155	893.00
VS-3264-A	72" Single-Face Shelving Adder	36 x 12 x 72	160	872.00
VS-3264-S	72" Single-Face Shelving Starter	37 x 12 x 72	190	1,004.00
VS-3265-A	84" Single-Face Shelving Adder	36 x 12 x 84	185	966.00
VS-3265-S	84" Single-Face Shelving Starter	37 x 12 x 84	220	1,112.00



VS-3261-S

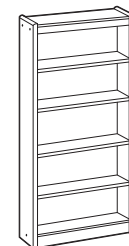

VS-3264-S

STANDARD FINISH: Natural Oak (NO), Medium Oak (MO)    STANDARD EDGE STYLES: Round-over, Fluted (beaded), Half-round, Custom

1211

All items are F.O.B. Missoula, MT 59802. Allow 4-6 weeks lead time for shipping.

# LIBRARY VISION SERIES

---

## 2012 Price List

**DOUBLE FACED SHELVING**

PAGE 2

Model #	Description	Product Size (W x D x H)	Ship Wt (lbs)	Suggested Retail
VS-3561-A	36" Double-Face Shelving Adder	36 x 21 <sup>3</sup> / <sub>4</sub> x 35	135	\$ 983.00
VS-3561-S	36" Double-Face Shelving Starter	37 x 21 <sup>3</sup> / <sub>4</sub> x 35	160	1,136.00
VS-3562-A	48" Double-Face Shelving Adder	36 x 21 <sup>3</sup> / <sub>4</sub> x 46	180	1,143.00
VS-3562-S	48" Double-Face Shelving Starter	37 x 21 <sup>3</sup> / <sub>4</sub> x 46	205	1,329.00
VS-3563-A	60" Double-Face Shelving Adder	36 x 21 <sup>3</sup> / <sub>4</sub> x 60	215	1,314.00
VS-3563-S	60" Double-Face Shelving Starter	37 x 21 <sup>3</sup> / <sub>4</sub> x 60	255	1,540.00
VS-3564-A	72" Double-Face Shelving Adder	36 x 21 <sup>3</sup> / <sub>4</sub> x 72	255	1,498.00
VS-3564-S	72" Double-Face Shelving Starter	37 x 21 <sup>3</sup> / <sub>4</sub> x 72	305	1,762.00
VS-3565-A	84" Double-Face Shelving Adder	36 x 21 <sup>3</sup> / <sub>4</sub> x 84	295	1,647.00
VS-3565-S	84" Double-Face Shelving Starter	37 x 21 <sup>3</sup> / <sub>4</sub> x 84	355	1,955.00

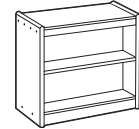

VS-3561-S



VS-3563-S

**SHELVING ACCESSORIES**

VS-DS-36	Display (Periodical) Shelf Accessory	35 x 2 x 14	10	\$ 158.00
VSL-36	Accessory Shelf	35 x 12 x 1	15	141.00
WS-3	Wire Book Stops (set of 3)	8 x 6 x 1/4	1	74.00
NPI-10	Newspaper Insert w/Five Rods	1 x 1 x 34	5	522.00
NPR	Newspaper Rod (each)	1 x 1 x 34"	5	37.00

**TECHNICAL**

VS-3001	Book Display	48 x 30 x 49	80	\$2,556.00
VS-3003	Magazine Display	48 x 17 x 48	170	2,212.00
VS-3004	Newspaper Stand	32 <sup>1</sup> / <sub>4</sub> x 36 x 48	95	1,538.00
VS-3005	Paperback or Video Rotating Display	26 x 26 x 51 <sup>3</sup> / <sub>4</sub>	300	3,135.00
VS-3013	Double Face Book Truck	40 x 16 x 36	125	1,518.00
VS-3015	Double Face Sloped Shelf Book Truck	40 x 24 x 36	160	1,808.00
VS-3017	Encyclopedia Display	40 x 16 x 36	110	1,712.00
VS-3026	Dictionary Stand	24 x 18 x 42	80	1,716.00
VS-3027	Atlas Stand	30 x 24 x 42	180	2,196.00
VS-3028	Revolving Dictionary Stand	24 x 20 x 37	100	1,568.00

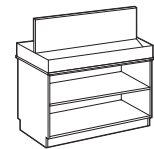

VS-3001

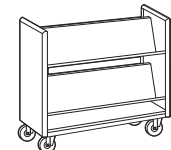

VS-3017

STANDARD FINISHES: Natural Oak (NO), Medium Oak (MO) STANDARD EDGE STYLES: Round-over, Fluted (beaded), Half-round, Custom

All items are F.O.B. Missoula, MT 59802. Allow 4-6 weeks lead time for shipping.

# LIBRARY VISION SERIES

---

## 2012 Price List

**STUDY CARREL**

PAGE 3

Model #	Description	Product Size (W x D x H)	Ship Wt (lbs)	Suggested Retail
VS-3021	Single Study Carrel	36 x 24 x 54	115	\$ 1,496.00
VS-3022	Back-to-Back Study Carrel	36 x 48 x 54	175	1,823.00
VS-3023	Side-by-Side Study Carrel	72 x 24 x 54	185	2,010.00
VS-3025	Reference Carrel	36 x 24 x 35	70	1,262.00
VS-3029	Computer Carrel	36 x 30 x 51	130	1,558.00

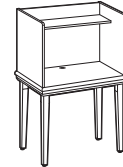

VS-3021

**TABLES**

Model #	Description	Product Size (W x D x H)	Ship Wt (lbs)	Suggested Retail
48R-OF-B4	HPL; 3mm Oak	48 x 48 x 30	100	\$ 726.00
48S-OF-B4	HPL; 3mm Oak	48 x 48 x 30	120	795.00
60R-OF-B4	HPL; 3mm Oak	60 x 60 x 30	140	939.00
60S-OF-B4	HPL; 3mm Oak	60 x 60 x 30	160	971.00
2448T-OF-B4	HPL; 3mm Oak	48 x 24 x 30	65	642.00
3060T-OF-B4	HPL; 3mm Oak	60 x 30 x 60	80	739.00

STANDARD FINISHES: Natural Oak (NO), Medium Oak (MO) STANDARD EDGE STYLES: Round-over, Fluted (beaded), Half-round, Custom

All items are F.O.B. Missoula, MT 59802. Allow 4-6 weeks lead time for shipping.